

FXM0802 | Shaft dia.(轴径) 8 Lead(导程)2mm | C3&C5 |

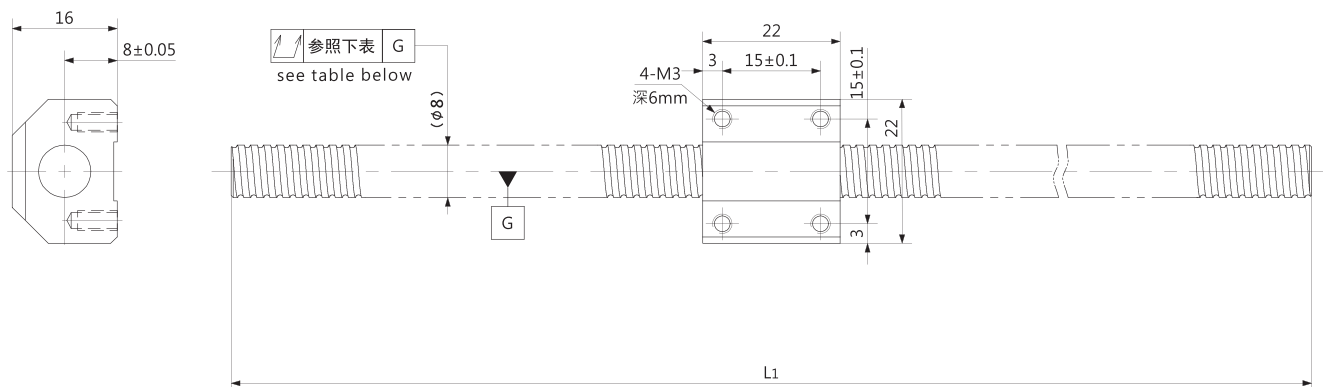

Unit (单位): mm

| Ball Screw Specifications | | 主要技术参数 |
|---------------------------|---------|---------------------------|
| Ball size 钢珠直径 | | φ1.0 |
| BCD 钢珠中心直径 | | 8.20 |
| Lead Angle 导程角 | | 4°26′ |
| Number of thread 螺纹条数 | | 1 |
| Thread direction 螺纹旋向 | | Right 右旋 |
| Shaft root dia 丝杠轴底径 | | φ7.1 |
| Number of circuit 循环数 | | 2.7×1 |
| Material 材质 | Shaft 轴 | S55C |
| | Nut 螺母 | SCM415H |
| Surface hardness 螺纹部表面硬度 | | HRC58~62 (Thread area) |
| Anti-rust treatment 防锈处理 | | Anti-rust oil 防锈油 |

Unit(单位): mm

| Ball Screw Model 滚珠丝杠型号 | Travel 行程 | Grade 精度 | Shaft length 丝杠轴长度 | Lead accuracy 导程精度 | | Total Run-out 全跳动 ↗↘ | Axial play 轴向间隙 0 Spacer ball 间隔钢珠 (1:1) | Preload Torque 预压扭矩 Nm | Basic Load Rating 基本额定负载 N | |
|----------------------------|--------------|-------------|-----------------------|---|-------------------------------------|----------------------------|---|------------------------------|-------------------------------|------------------------|
| | | | L ₁ | Travel deviation 代表移动量误差 e _p | Variation 波动 V ₃₀₀ | | | | Dynamic 额定动负载 Ca | Static 额定静负载 Coa |
| FXM0802-074R124 | 97 | C3 | 124 | ±0.008 | 0.008 | 0.060 | 0.004~0.020 | 540 | 800 | |
| FXM0802-104R154 | 127 | | 154 | ±0.010 | | | | | | |
| FXM0802-134R184 | 157 | | 184 | ±0.010 | | | | | | |
| FXM0802-184R234 | 207 | | 234 | ±0.010 | | | | | | |
| FXM0802-074R124 | 97 | C5 | 124 | ±0.018 | 0.018 | 0.090 | - | 850 | 1600 | |
| FXM0802-104R154 | 127 | | 154 | ±0.020 | | | | | | |
| FXM0802-134R184 | 157 | | 184 | ±0.020 | | | | | | |
| FXM0802-184R234 | 207 | | 234 | ±0.020 | | | | | | |

Note) Please designate end-journal profile with your sketch. (注) 轴端的追加加工请结合图纸进行指示。