

# GSR0802.5T | Shaft dia.(轴径) 8 Lead(导程)2.5mm | C5&Ct7&Ct10 |

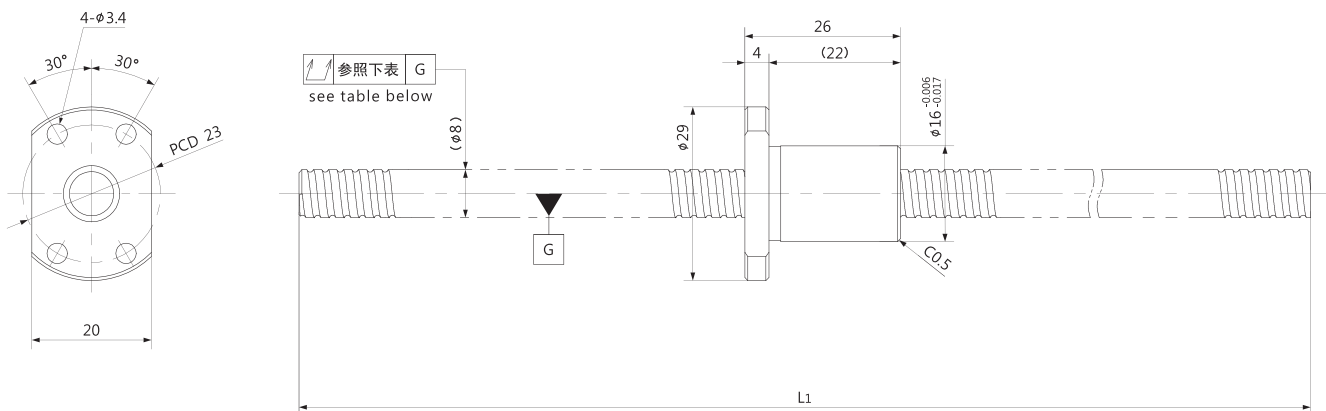

Unit (单位): mm

| Ball Screw Specifications |         | 主要技术参数                    |
|---------------------------|---------|---------------------------|
| Ball size 钢珠直径            |         | φ1.2                      |
| BCD 钢珠中心直径                |         | 8.41                      |
| Lead Angle 导程角            |         | 5°41′                     |
| Number of thread 螺纹条数     |         | 1                         |
| Thread direction 螺纹旋向     |         | Right 右旋                  |
| Shaft root dia 丝杠轴底径      |         | φ7.0                      |
| Number of circuit 循环数     |         | 1×3                       |
| Material 材质               | Shaft 轴 | S55C                      |
|                           | Nut 螺母  | SCM415H                   |
| Surface hardness 螺纹部表面硬度  |         | HRC58~62<br>(Thread area) |
| Anti-rust treatment 防锈处理  |         | Anti-rust oil 防锈油         |

Unit(单位): mm

| Ball Screw Model<br>滚珠丝杠型号 | Travel<br>行程 | Grade<br>精度 | Shaft length<br>丝杠轴长度<br>$L_1$ | Lead accuracy<br>导程精度                |                              | Total Run-out<br>全跳动<br> | Axial play<br>轴向间隙 | Preload Torque<br>预压扭矩<br>Nm | Basic Load Rating<br>基本额定负载 N |                             |
|----------------------------|--------------|-------------|--------------------------------|--------------------------------------|------------------------------|--------------------------|--------------------|------------------------------|-------------------------------|-----------------------------|
|                            |              |             |                                | Travel deviation<br>代表移动量误差<br>$e_p$ | Variation<br>波动<br>$V_{300}$ |                          |                    |                              | Dynamic<br>额定动负载<br>$C_a$     | Static<br>额定静负载<br>$C_{0a}$ |
| GSR0802.5T-1200R1200C5     | 1175         | C5          | 1200                           | ±0.046                               | 0.018                        | 0.150                    | ~0.005             | -                            | 1300                          | 2300                        |
| GSR0802.5T-1200R1200C7     | 1175         | Ct7         | 1200                           | ±0.208                               | 0.052                        | 0.320                    | ~0.020             |                              |                               |                             |
| GSR0802.5T-1200R1200C10    | 1175         | Ct10        | 1200                           | ±0.840                               | 0.210                        | 0.640                    | ~0.050             |                              |                               |                             |

Note) Please designate end-journal profile with your sketch. 注) 轴端的追加加工请结合图纸进行指示。